

RECOMMENDED PCB LAYOUT (TOP VIEW)

MATERIAL
 INSULATOR: GLASS-REINFORCED THERMOPLASTIC.
 CONTACT: COPPER ALLOY.
 PLATING: WELDING AREA - SELECTED GOLD OVER NICKEL.
 SOLDER AREA - TIV/LEAD OVER NICKEL.

ELECTRICAL
 VOLTAGE RATING: 250 VAC RMS.
 CURRENT RATING: 1 AMP.
 DELTA I: WITHSTANDING VOLTAGE: 500 VAC RMS @ 50 HZ FOR 1 MINUTE.
 INSULATION RESISTANCE: 1000 MEGOHMS MIN AT 500 VDC.
 CONTACT RESISTANCE: 30 MILLIOHMS MAX.

MECHANICAL
 RETENTION FORCE: 480 GRAMS MIN PER CONTACT PAIR.
 INSERTION FORCE: 230 GRAMS MAX PER CONTACT PAIR.
 WITHDRAWAL FORCE: 15 GRAMS MIN PER CONTACT PAIR.
 ENVIRONMENTAL
 TEMPERATURE RANGE: -55°C TO +85°C.

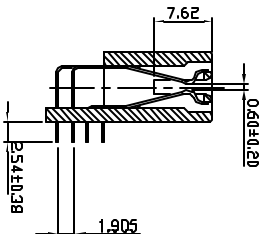

TOLERANCE	
LINEAR	ANGLES
X ± 0.20	X ±
X ± 0.15	X ±

Sullins Electronics
 San Marcos, CA
 WWW.SULLINSELECTRONICS.COM

TITLE: 64 BIT PCI CONN , 3.3V TYPE RIGHT ANGLE
 PART NO. TRWB0920KAV-1329
 DWG NO. 1329

REV	ECN NO.	NAME	DATE	APPD.	CHKD.	FINISH:	MATL:
A	0601	Jason	90.06.01				
			XXXXX.05				

UNITS	SCALE	SHEET	REV
MM	2 : 1	1 OF 1	A